

A detailed illustration of a medieval battle scene. In the foreground, a knight in a yellow and blue striped surcoat and a grey cap holds a sword. To his right, a knight in a blue and white striped surcoat is in a dynamic pose, holding a sword aloft. In the background, other knights are engaged in combat, one with an axe. The scene is set in a valley with stone walls on either side, under a sunset sky. A monk in a dark robe is visible on a cliff in the upper right.

# MCCLXV Evesham

FLOOR PLANS  
AND BATTLE MAPS  
PAST  ADVENTURES

© Past Adventures

[www.pastadventures.com](http://www.pastadventures.com)



# CLAXBY MANOR

© Past Adventures

10-yard hexes

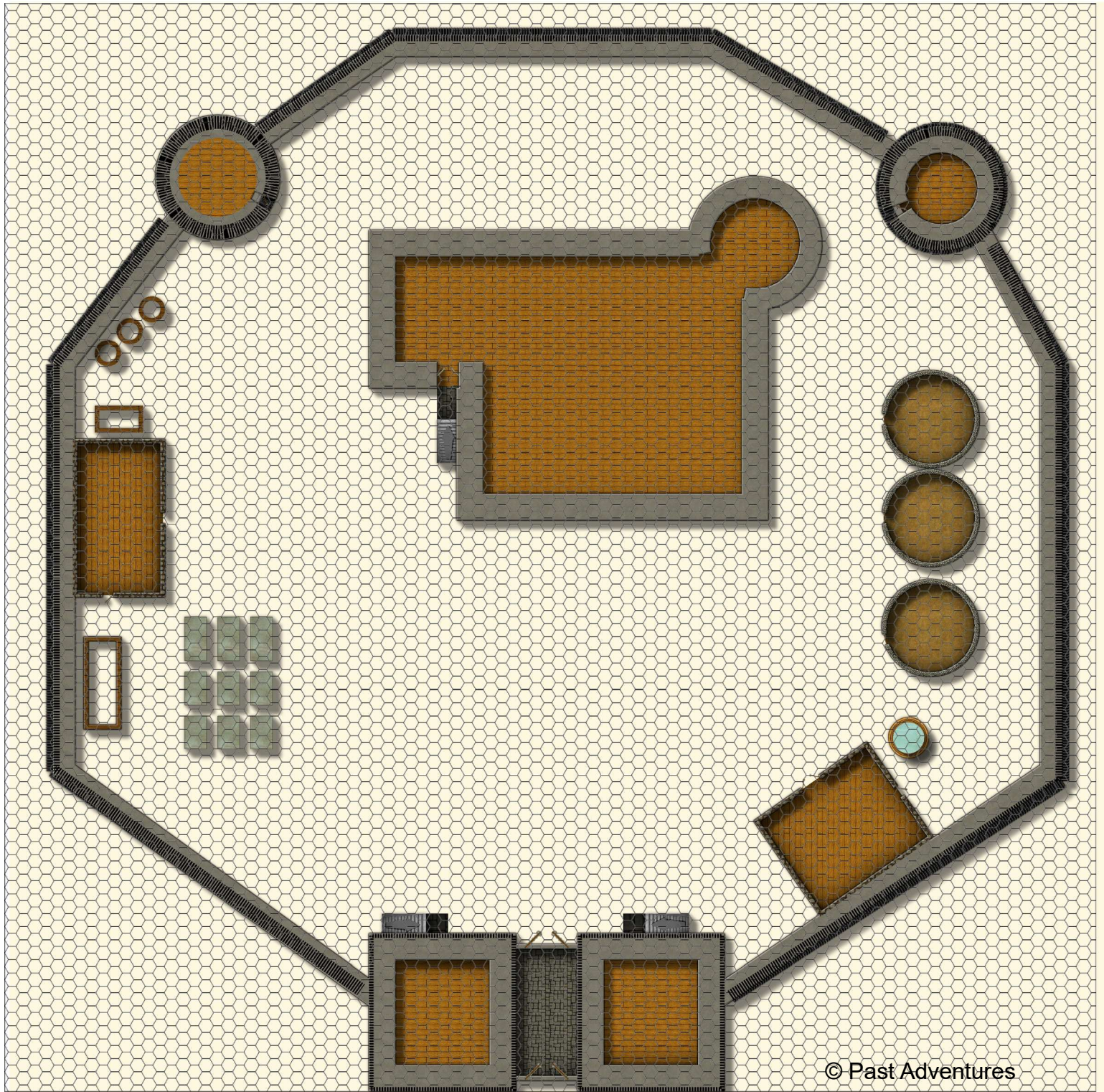

© Past Adventures

# CASTLE INNER BAILEY

1-yard hexes

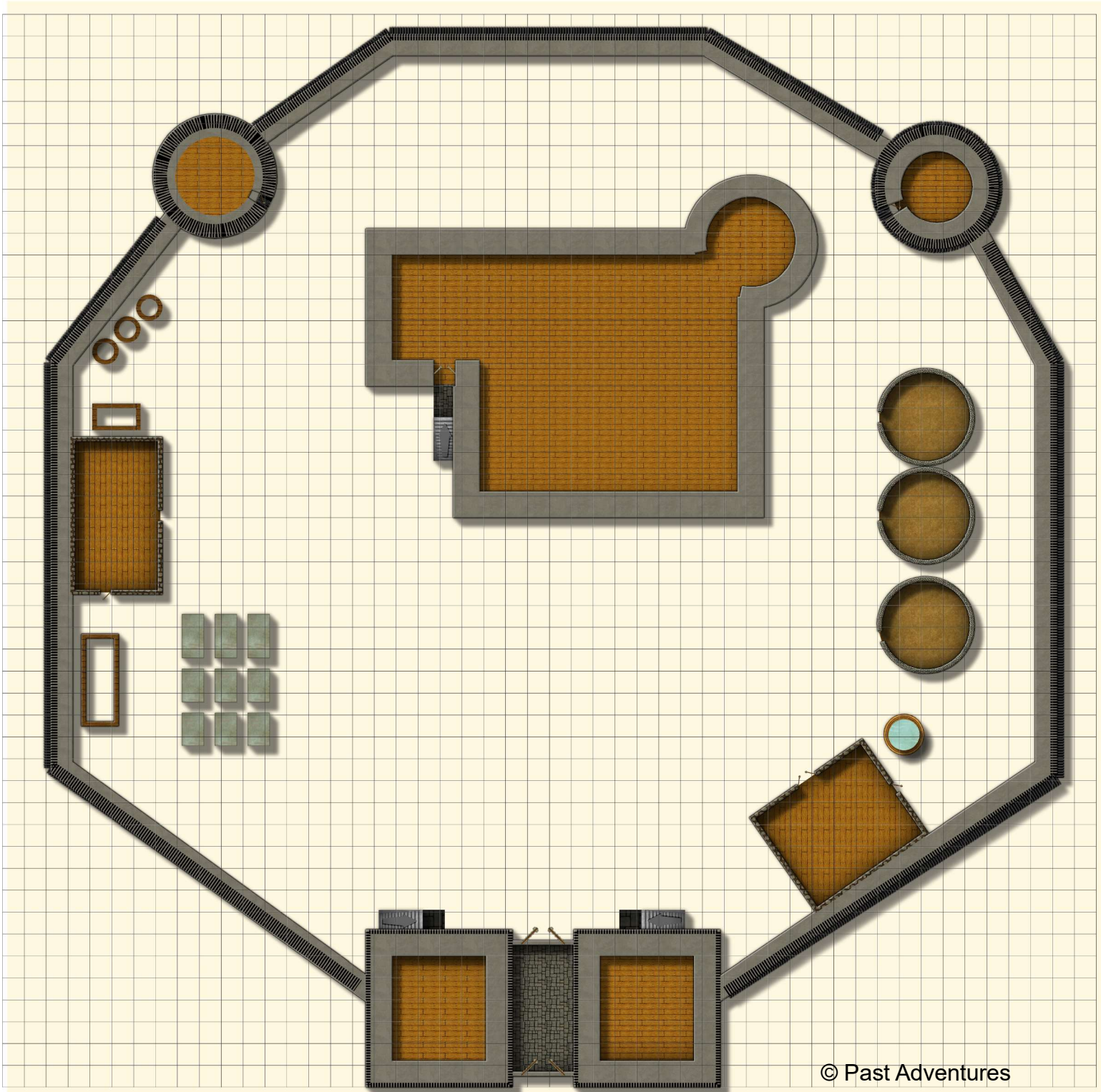

© Past Adventures

# CASTLE INNER BAILEY

5-foot squares

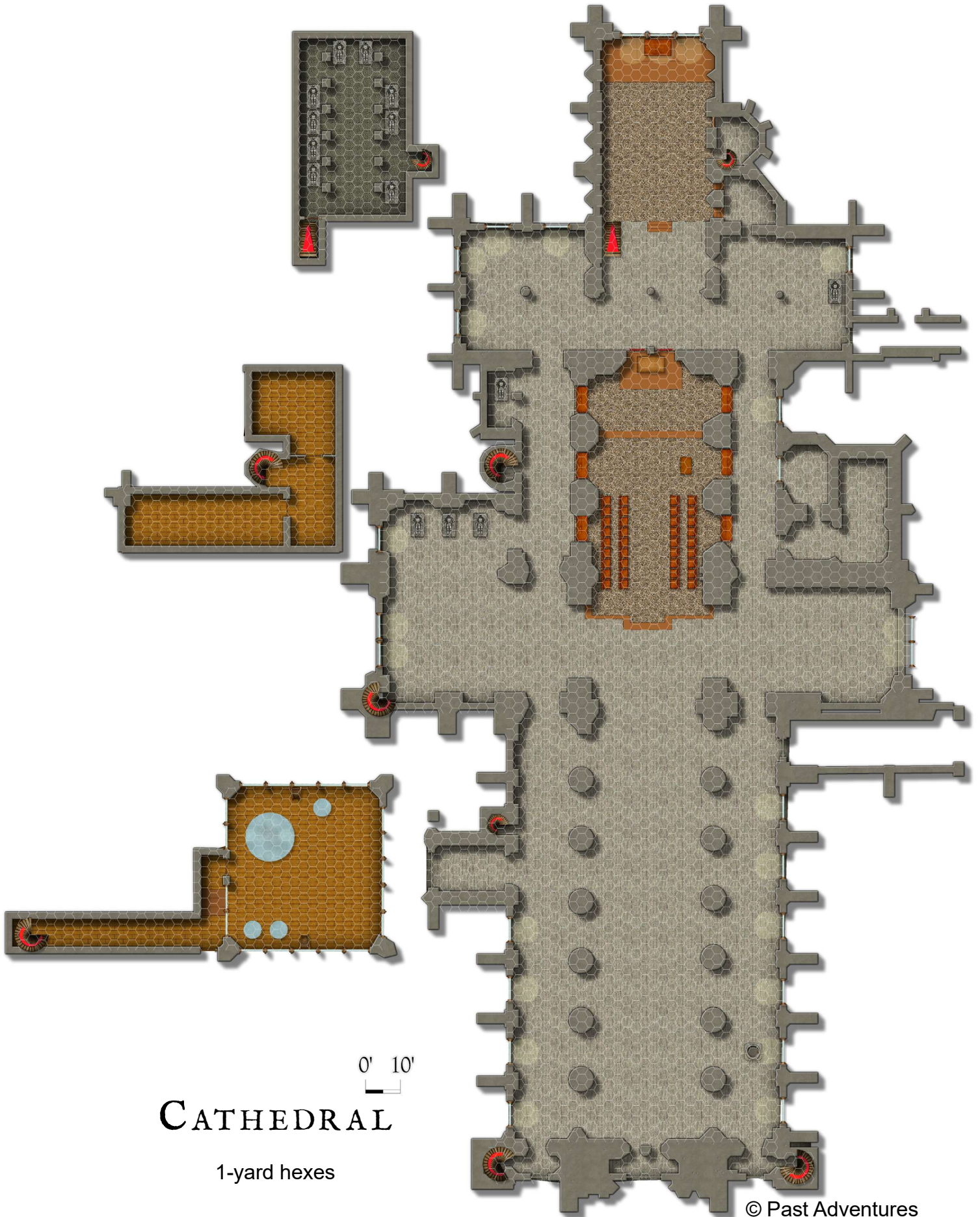

0' 10'  
**CATHEDRAL**  
1-yard hexes

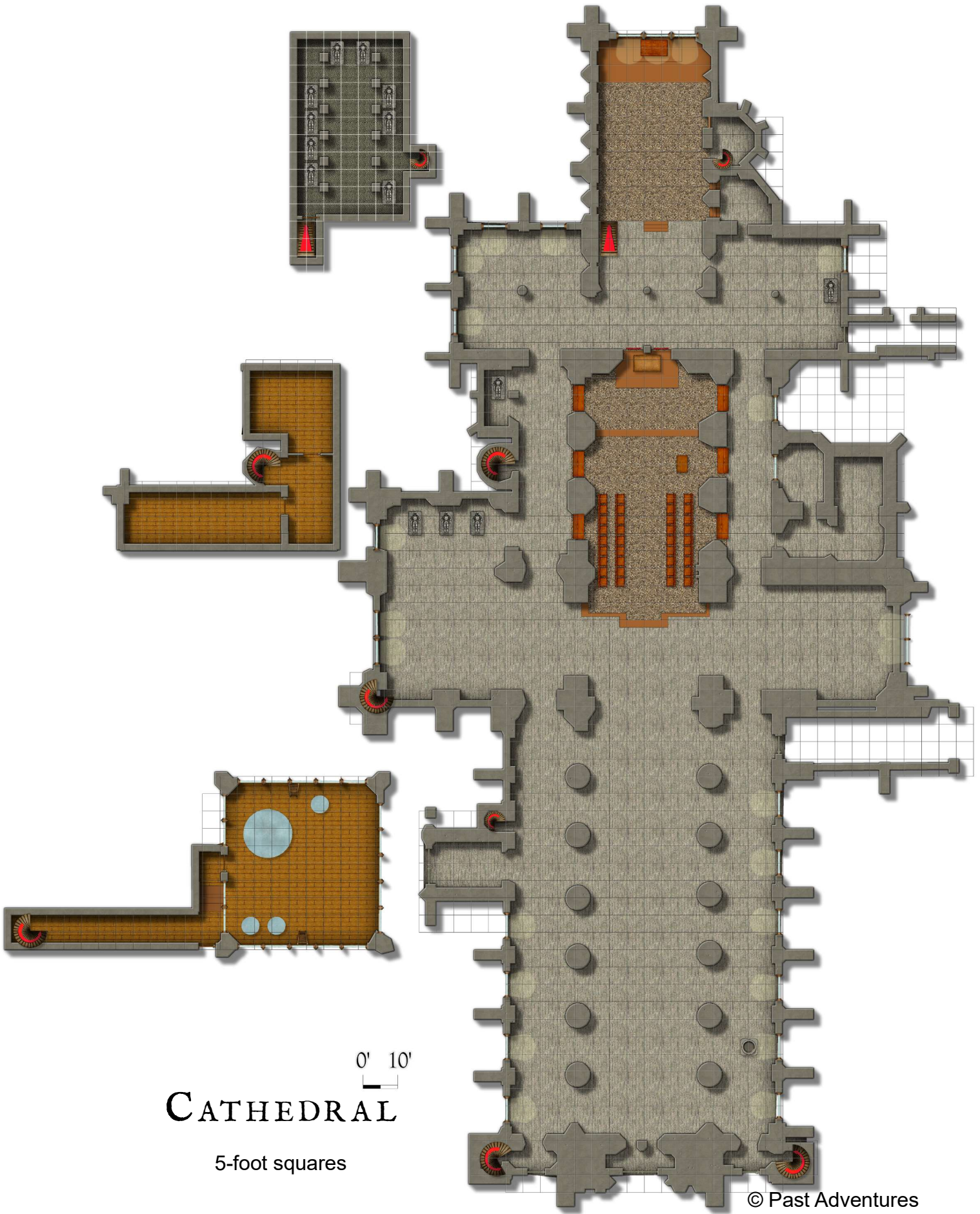

0' 10'

# CATHEDRAL

5-foot squares

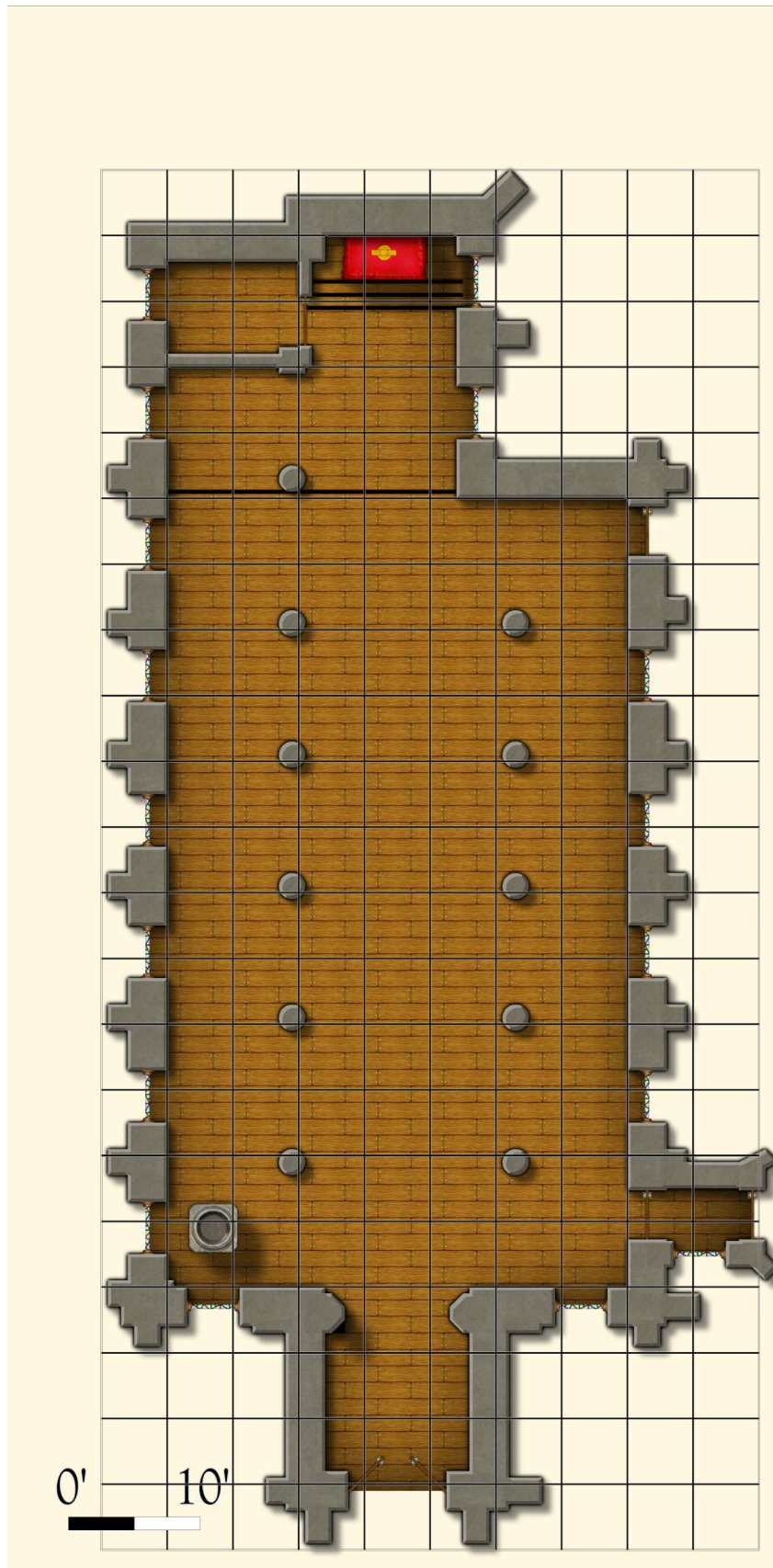

5-foot squares

# PARISH CHURCH

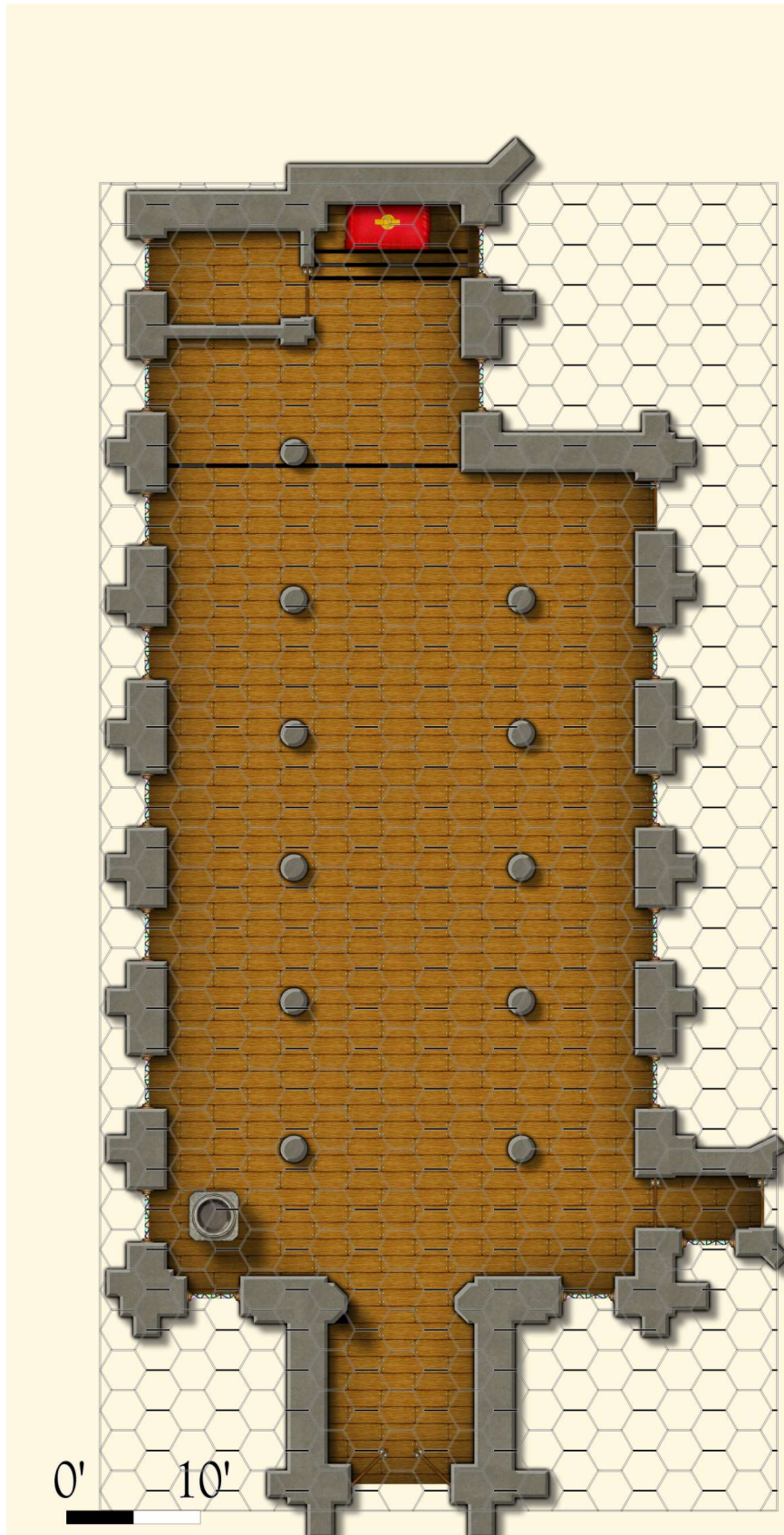

1-yard hexes

# PARISH CHURCH



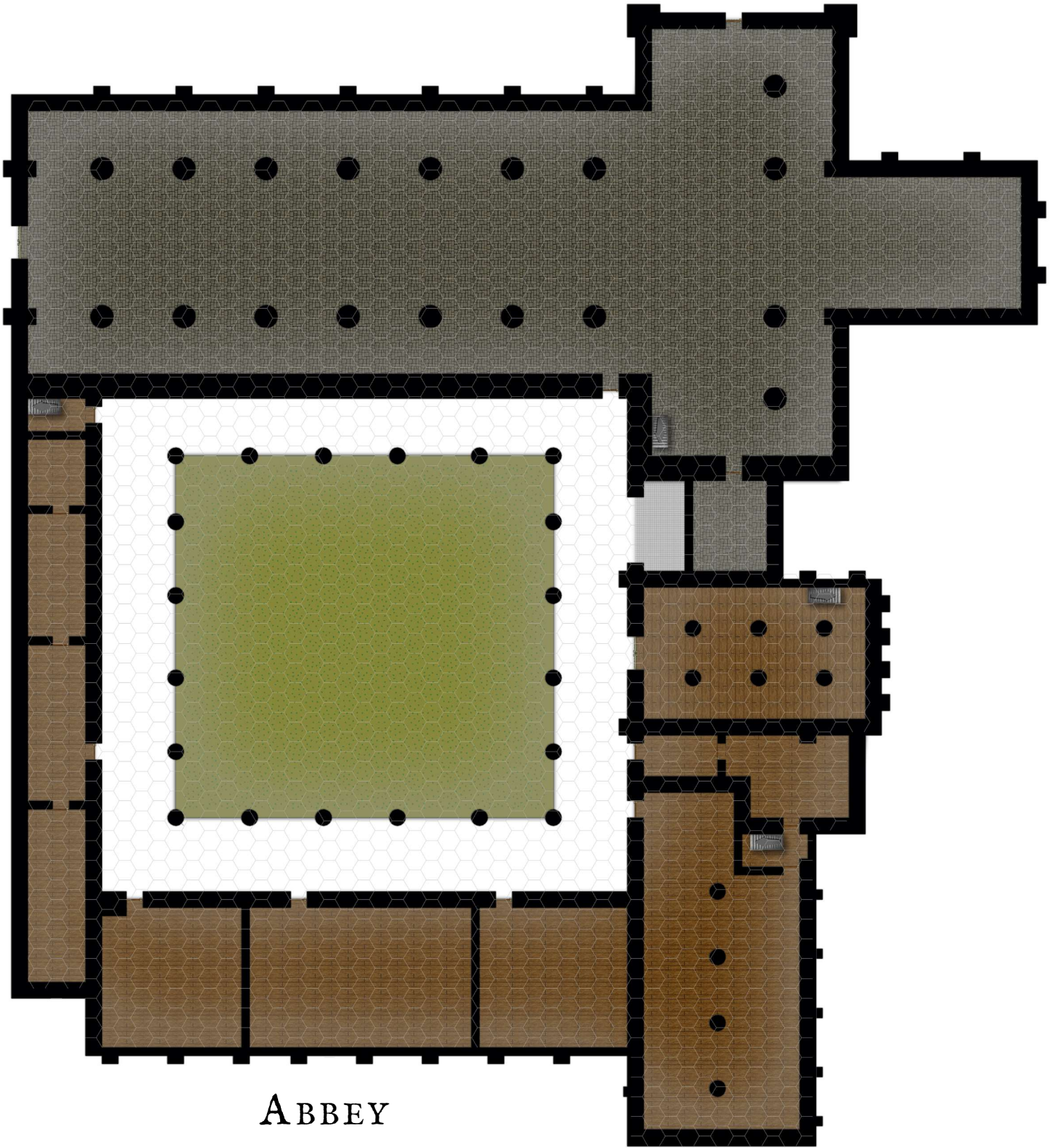

ABBEY

1-yard hexes

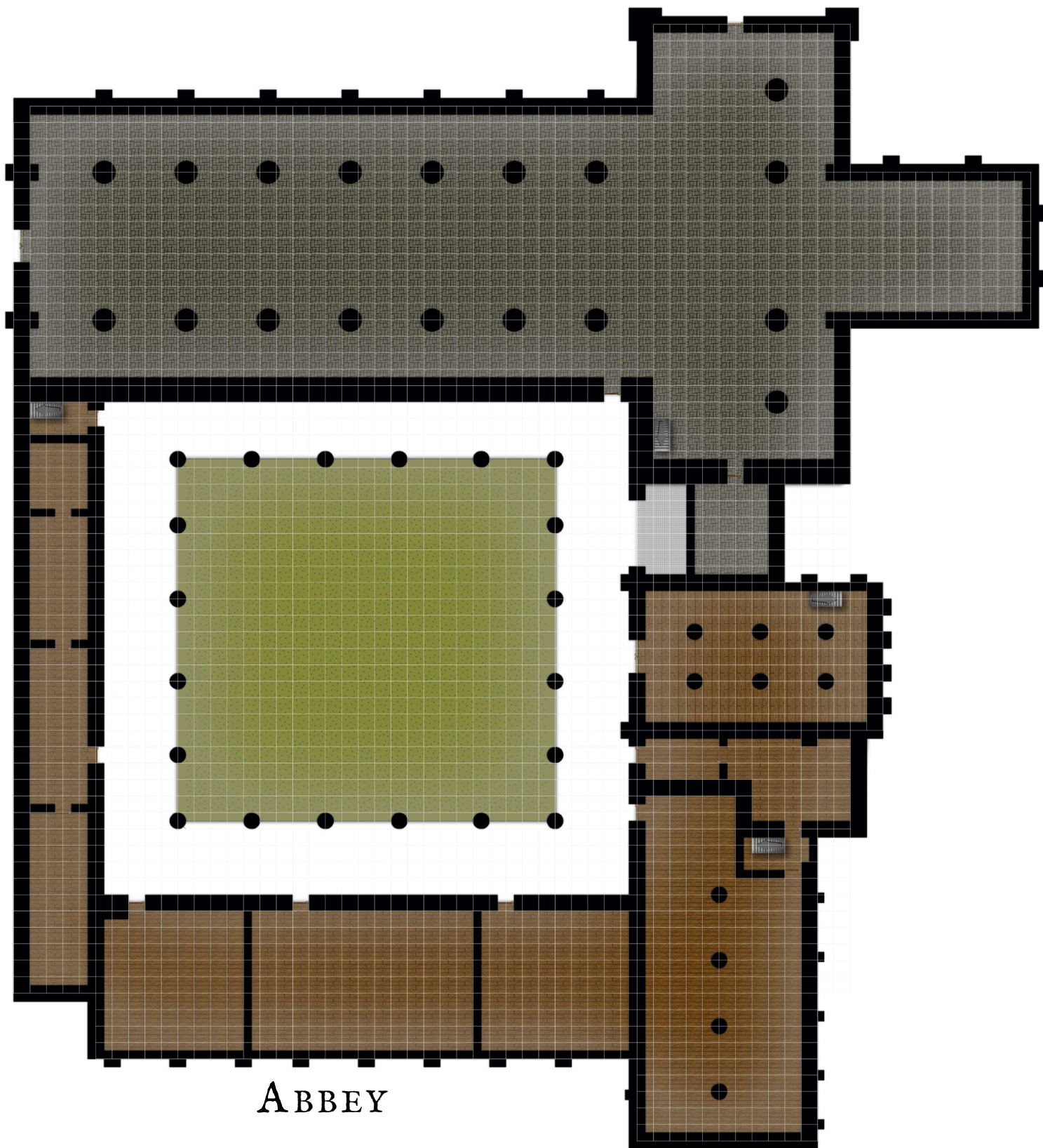

ABBEEY

5-foot squares

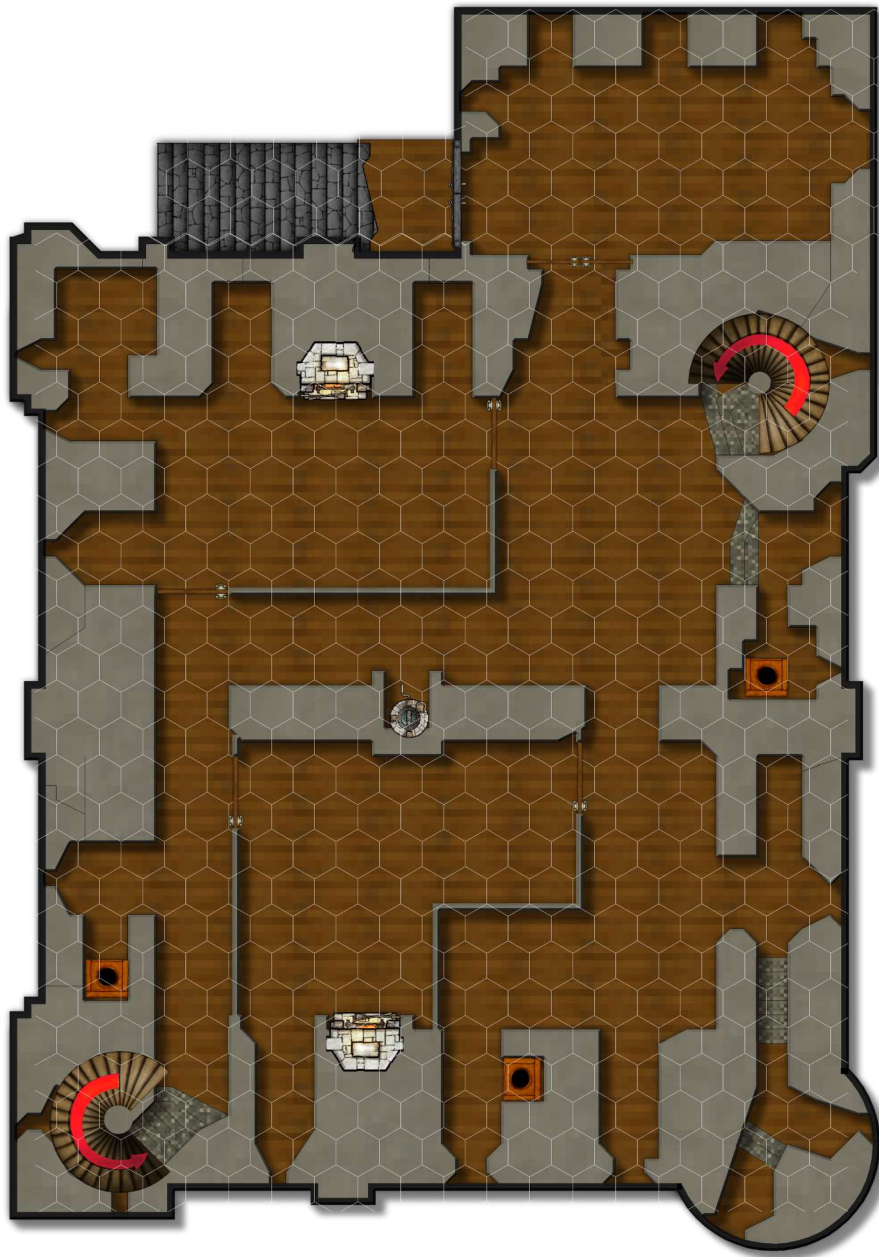

# KEEP GROUND FLOOR

1-yard hexes

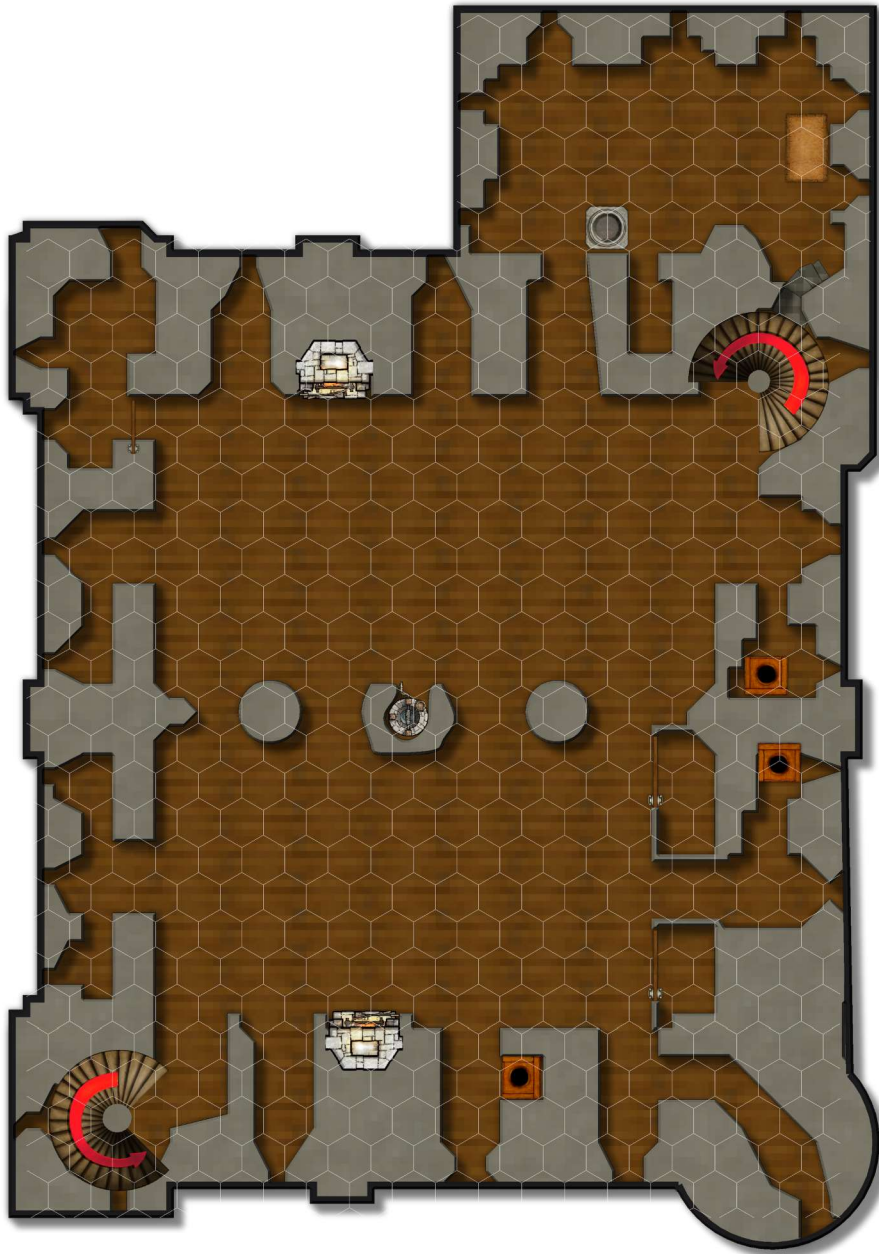

## KEEP MAIN FLOOR

1-yard hexes

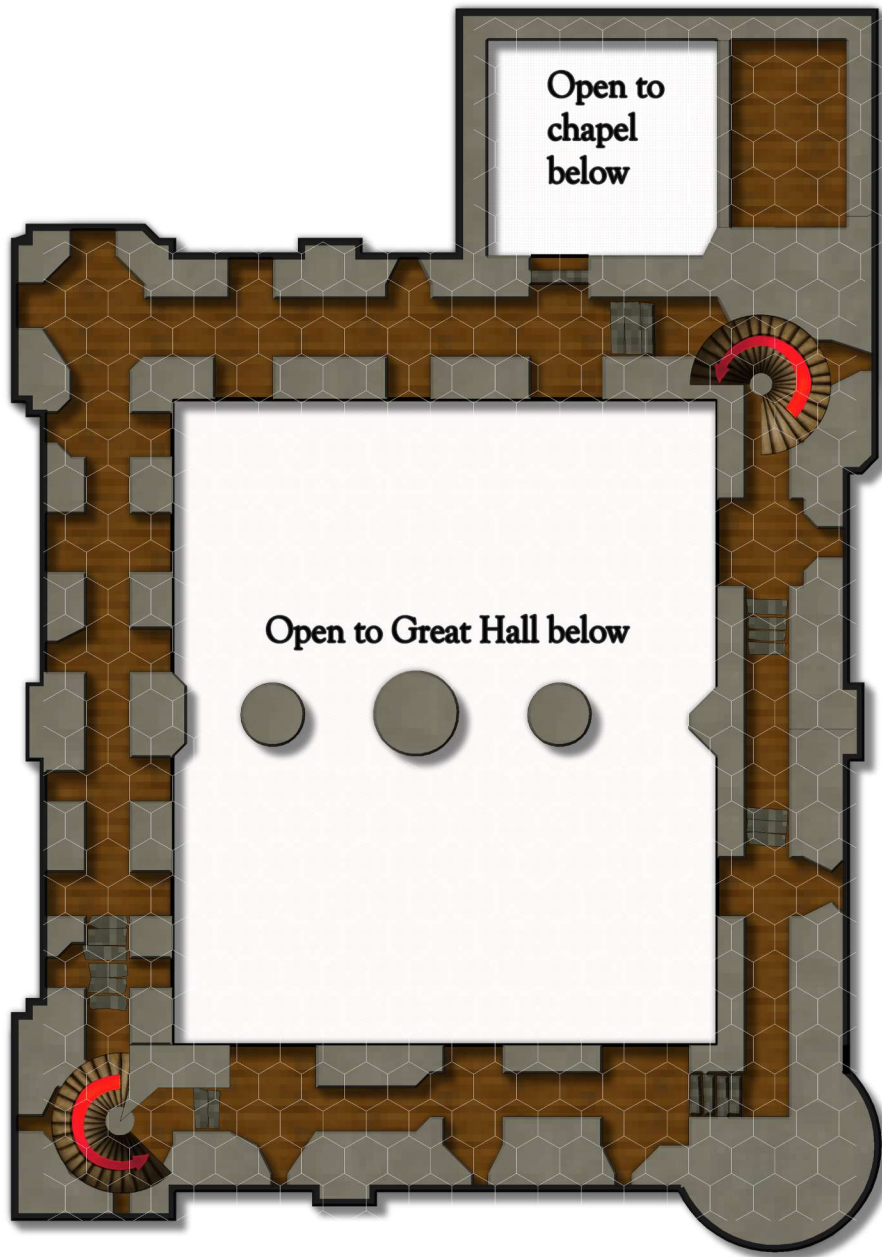

# KEEP GALLERY LEVEL

1-yard hexes

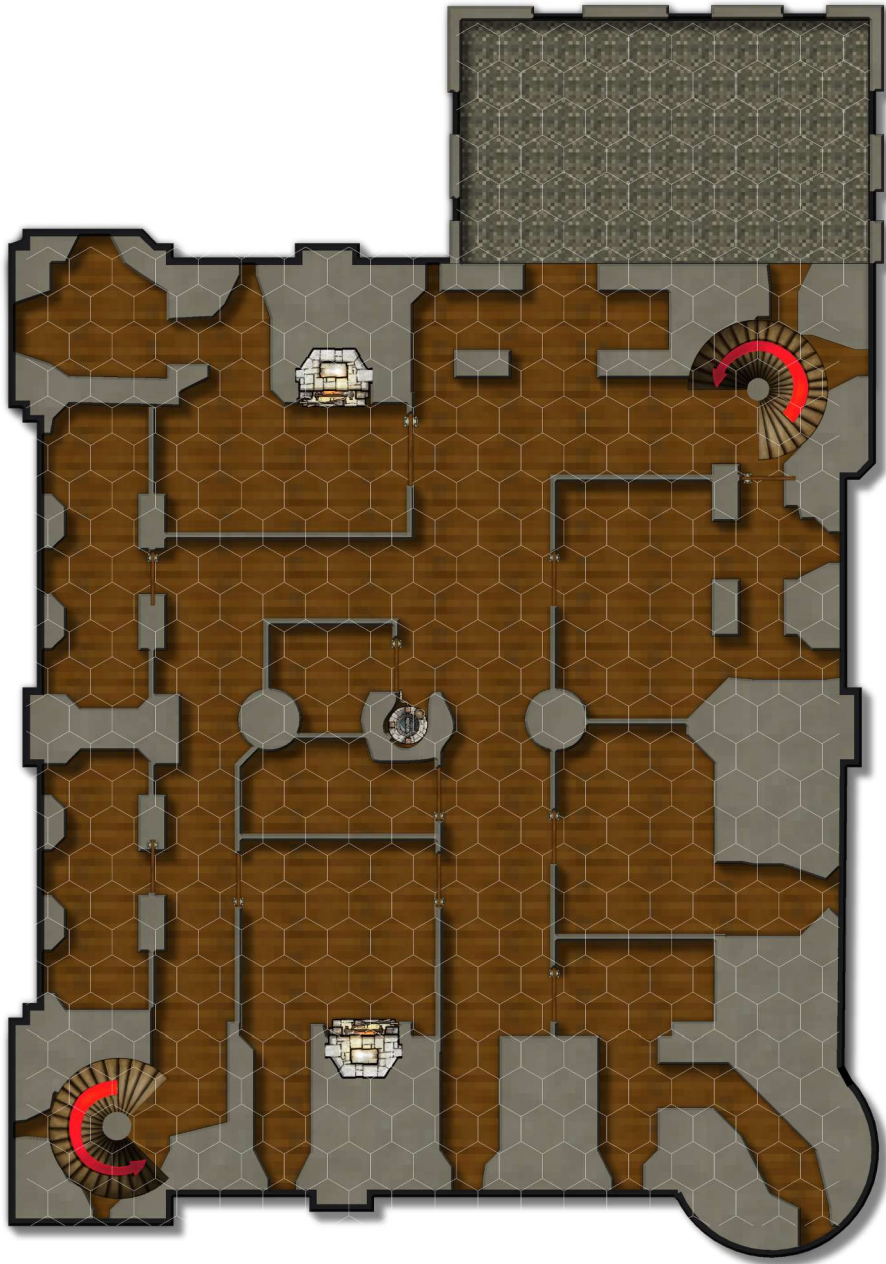

# KEEP THIRD FLOOR

1-yard hexes

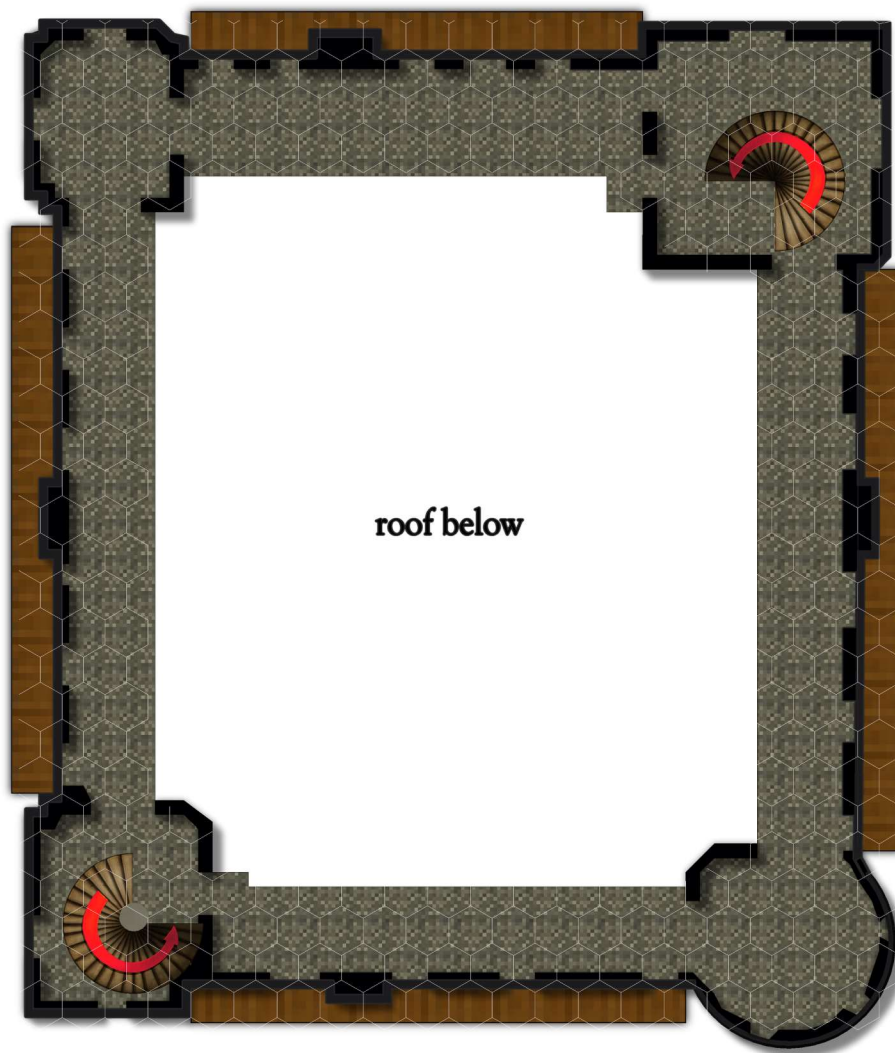

## KEEP BATTLEMENTS

1-yard hexes



# KEEP GROUND FLOOR

5-foot squares





# KEEP

5-foot squares

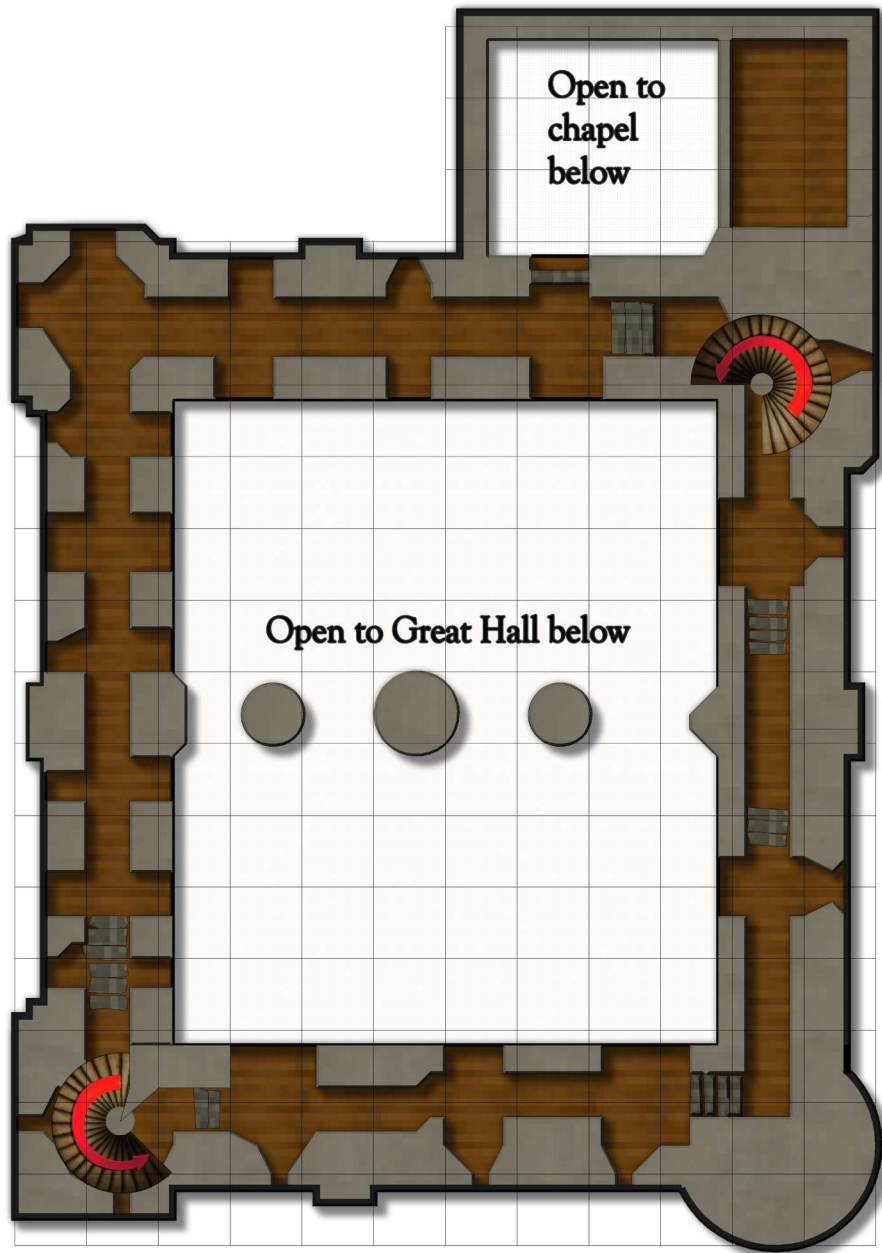

# KEEP GALLERY LEVEL

5-foot squares



# KEEP THIRD FLOOR

5-foot squares

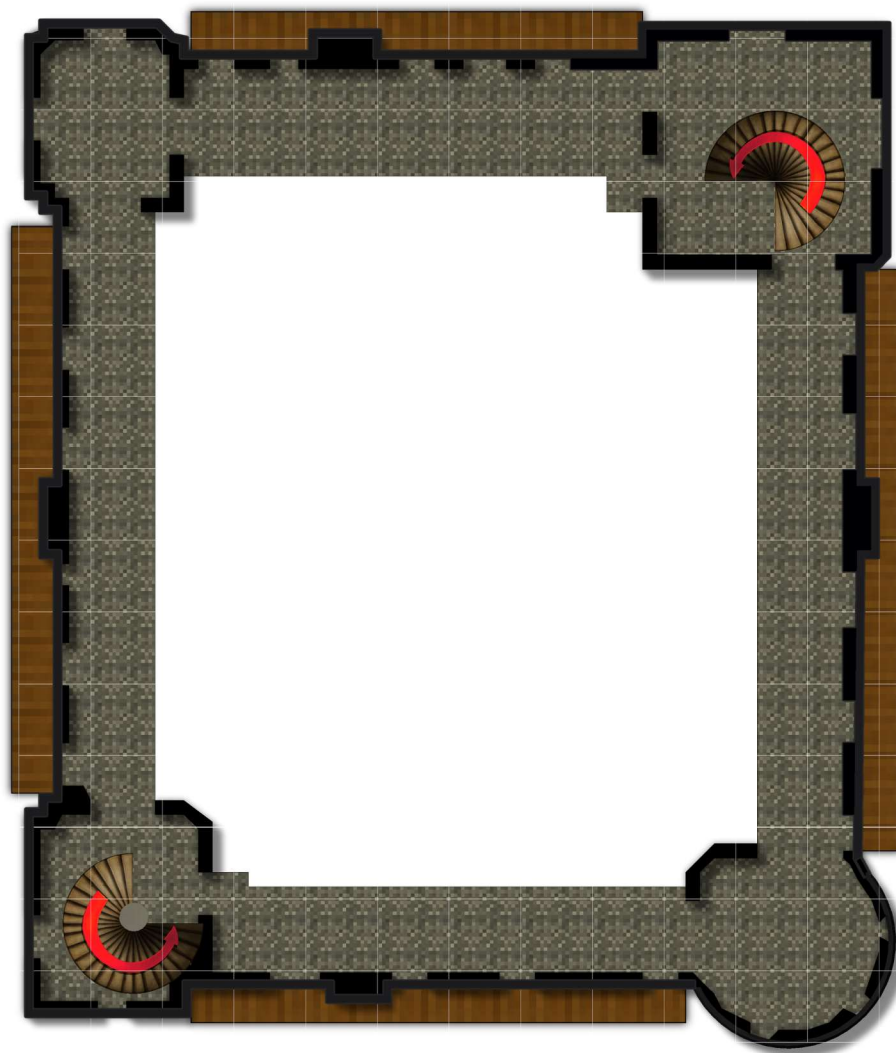

# KEEP BATTLEMENTS

5-foot squares

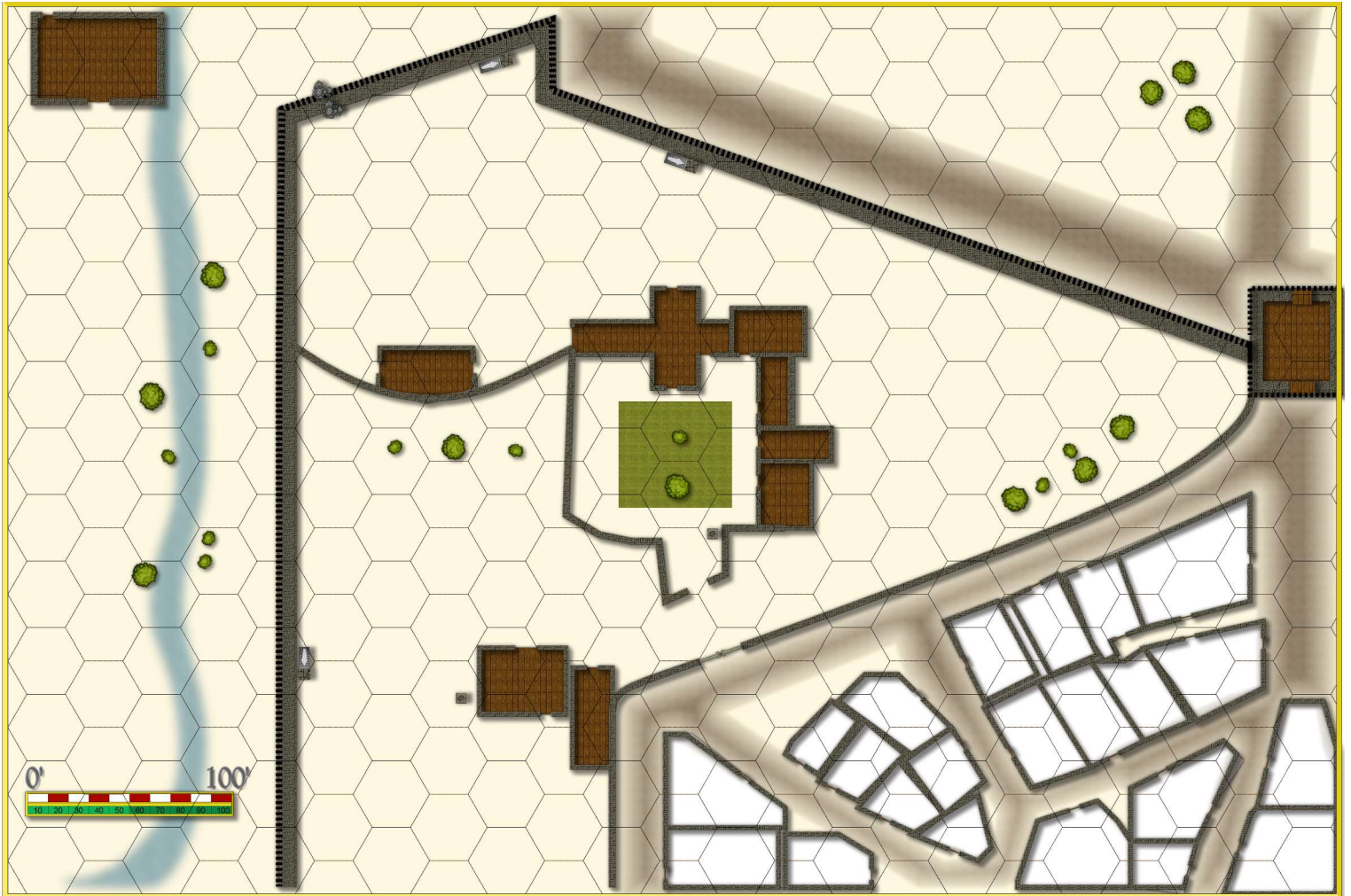

# NORTHAMPTON BREACH

10-yard hexes

© Past Adventures

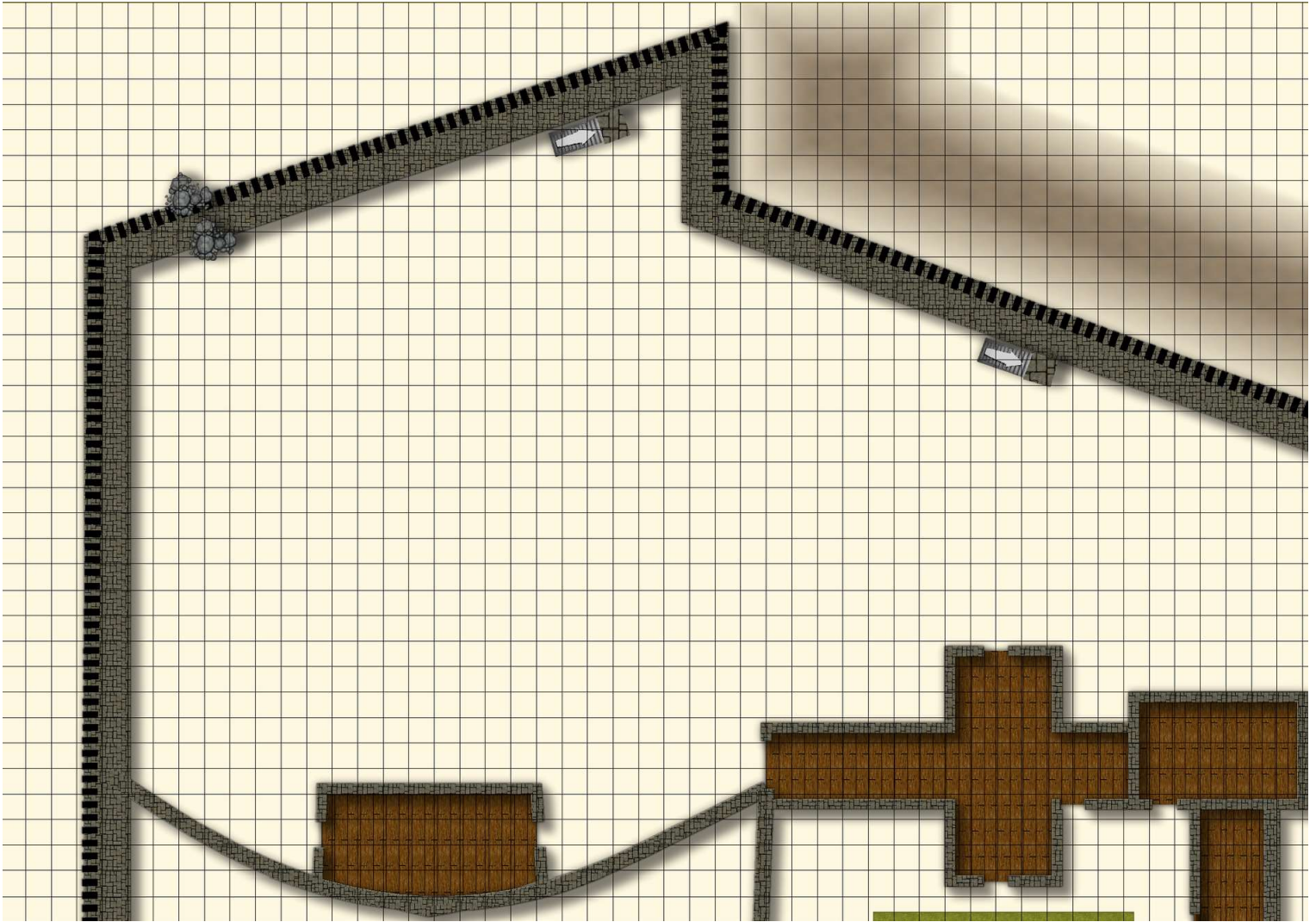

# NORTHAMPTON BREACH CLOSEUP

5-foot squares

© Past Adventures

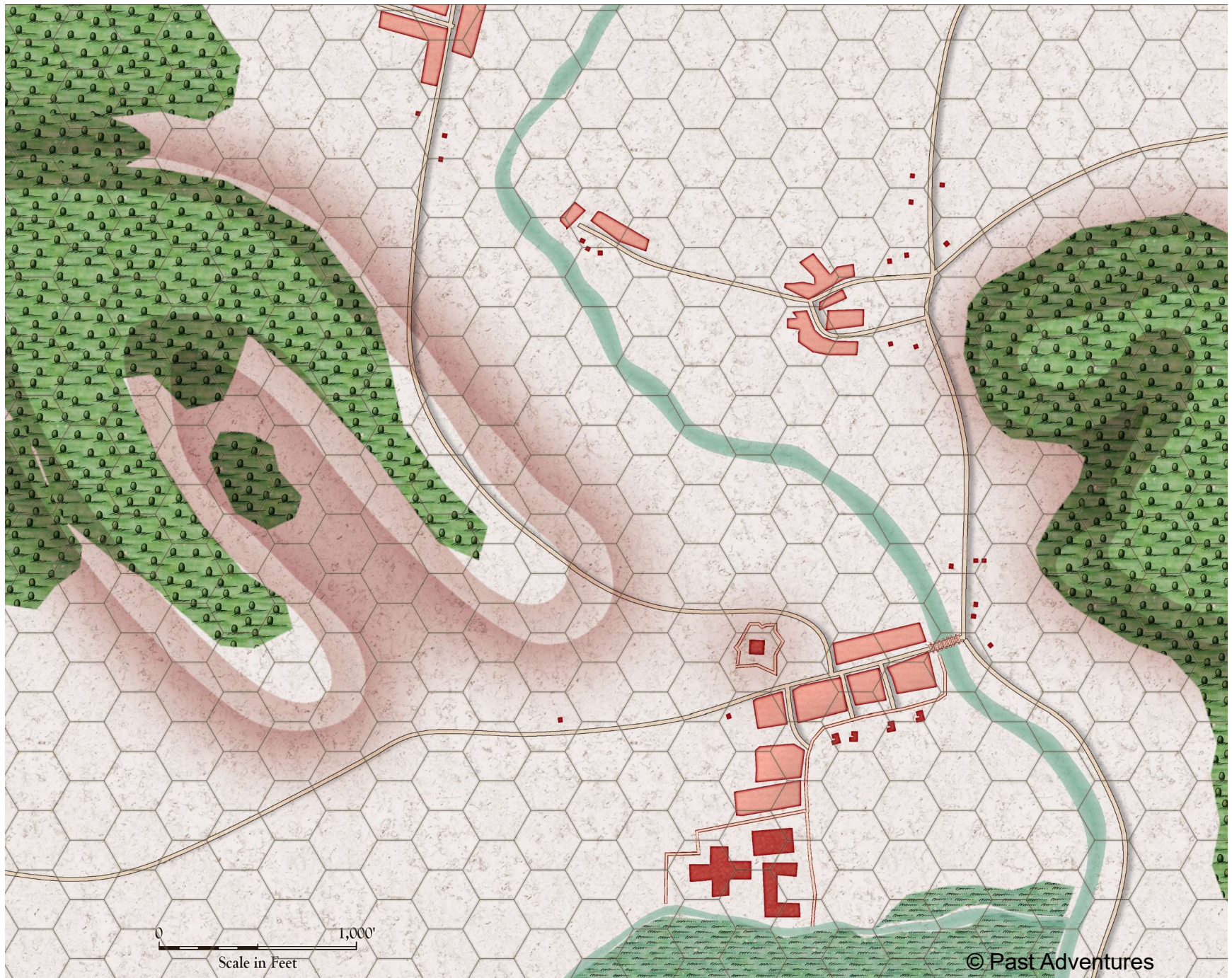

# BATTLE OF LEWES

100-yard hexes



# KENILWORTH CASTLE

10-yard hexes



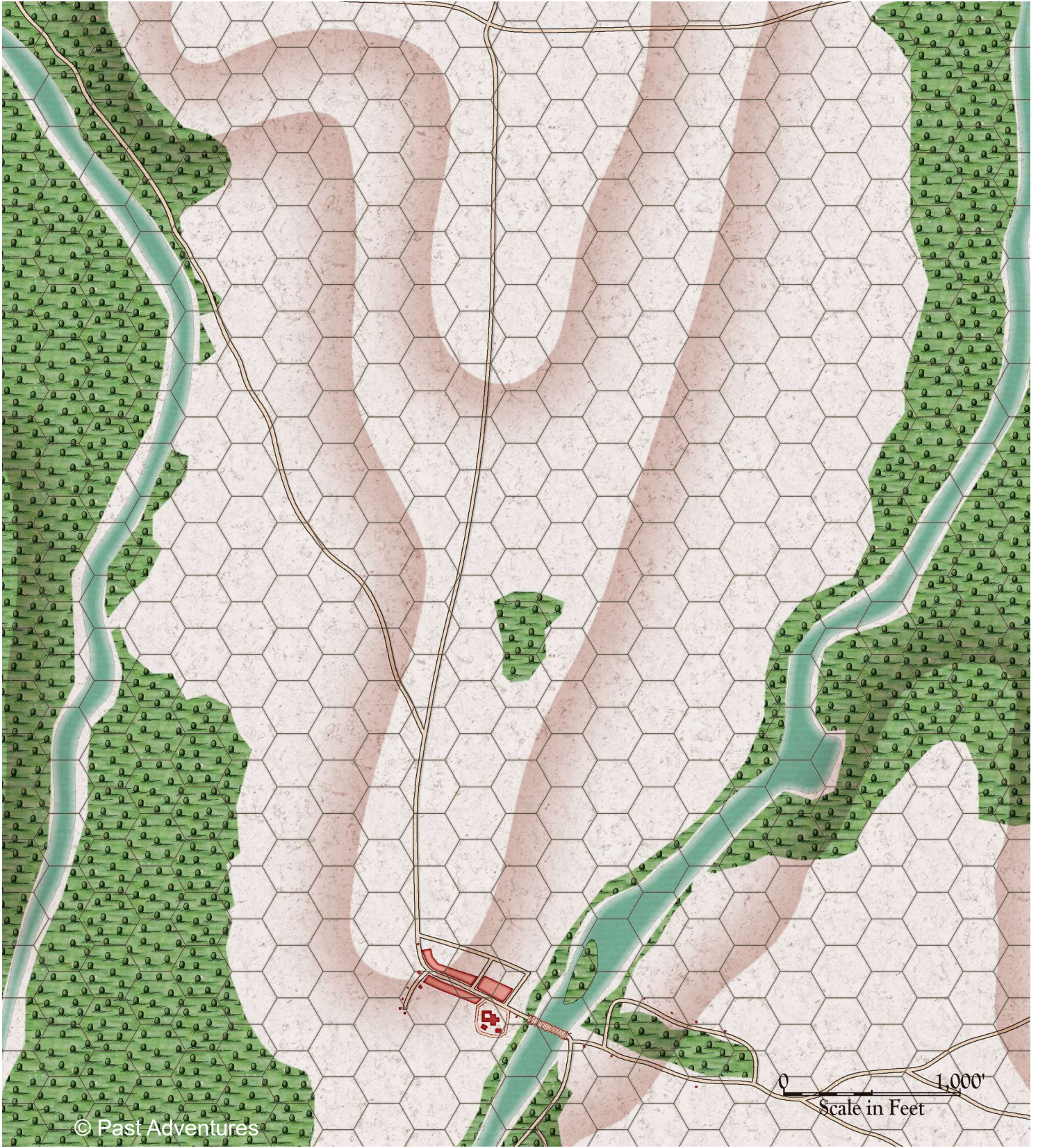

# BATTLE OF EVESHAM

100-yard hexes